



ROUGHING VACUUM COMPONENTS





Roughing Components

Roughing Components Section General Introduction..... 11.3

- Flexible Nipple (Bellows) – ISO-QF flanges..... 11.4
- Flexible Nipple (Bellows) – CF flanges..... 11.4
- Flexible Nipple (Bellows) – ISO-LF flanges 11.5
- Flexible Nipple (Bellows) – ASA/ANSI flanges 11.5
- Flexible Metal Hose – Thin Wall, ISO-QF and LF flanges..... 11.6
- Flexible Metal Hose – Medium Wall, ISO-QF and LF flanges..... 11.7
- Flexible Metal Hose – Thin Wall, CF flanges..... 11.8
- Flexible Metal Hose – Medium Wall, CF flanges..... 11.9
- Flexible Metal Hose – Thin Wall, Weldable end..... 11.10
- Flexible Metal Hose – Medium Wall, Weldable end..... 11.11
- Flexible PVC Hose – Wire reinforced, ISO-QF flange..... 11.12
- Flexible PVC Hose – Wire reinforced, cut to length 11.12
- Flexible Hose Adapter to ISO-QF – Aluminum..... 11.13
- Flexible Hose Adapter to ISO-QF – Stainless Steel..... 11.13
- Flexible Hose Clamps 11.13
- PVC ISO-QF flanges 11.14
- PVC Couplings 11.14
- PVC Sealant..... 11.14
- PVC 45° Elbow..... 11.15
- PVC 90° Elbow..... 11.15
- PVC Tee 11.15
- PVC Tubing..... 11.15

A&N Corporation

707 SW 19th Ave.
Williston, FL 32696
1(800) FLANGE1
FAX (352) 528-3441
www.ancorp.com

Roughing Vacuum COMPONENTS



This section offers a selection of products for the rough vacuum section of your system. Flexible vacuum hose assists in connecting sections of your system that are misaligned or with vibration isolation. PVC vacuum fittings and tubing are an economical means of running rough vacuum and exhaust lines.

Overview

Vacuum flexible hose is the best solution for misaligned vacuum ports or for those applications where straight plumbing is simply not an option. These products are also excellent vibration dampeners. Flexible vacuum hose is available in stainless steel or wire-reinforced PVC.

PVC vacuum fittings are an excellent money saving option for rough vacuum plumbing and exhaust lines. One advantage provided by PVC fittings is easy on site customization of the fittings and tubing that you purchase. Simply cut to size and assemble your system with the fittings, primer and cement. Adapter fittings to connect your PVC tubing to ISO-QF flanges and fittings are available as standard product.





ISO-QF Flexible Nipple (Bellows)

Materials

- Flanges
- 304 stainless steel
- Flexible hose
- 321 stainless steel

Product Notes

- Corrects misaligned connections

Options: Call for price and delivery

- Custom lengths
- Custom flange combination
- ISO-QF large size flanges see pg. 5.4

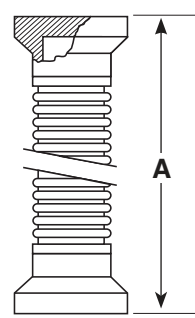

PART NUMBER	REFERENCE NUMBER	HOSE I.D.	WALL	A
0800000	QF16-075-F	0.75	0.006	4.00
0800001	QF25-100-F	1.00	0.006	4.00
0800002	QF40-150-F	1.50	0.006	4.00
0800003	QF50-200-F	2.00	0.006	4.00



CF Flexible Nipple (Bellows)

Materials

- Flanges - 304 stainless steel
- Flexible hose
- 321 stainless steel formed bellows

Product Notes

- Corrects misaligned connections
- Compress up to 20% or extend up to 15% of free length

Options: Call for price and availability

- Custom lengths
- Tapped flanges
- Custom flange combination
- Alternative materials (i.e. 316L stainless steel)

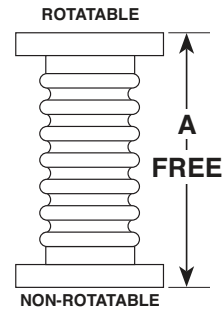

PART NUMBER	REFERENCE NUMBER	FLANGE TYPE	HOSE I.D.	WALL THICKNESS	A
0800089	133-F	CF133	0.75	0.006	4.00
0800092	212-F	CF212	1.00	0.006	4.00
0800095	275-F	CF275	1.50	0.006	4.00
0800098	338-F	CF338	2.00	0.006	4.00
0800099	450-F	CF450	2.50	0.008	6.00
0800100	462-F	CF462	3.00	0.008	6.00
0800101	600-F	CF600	4.00	0.010	6.00
0800103	800-F	CF800	6.00	0.012	8.00

A&N Corporation

707 SW 19th Ave.
Williston, FL 32696
1(800) FLANGE1
FAX (352) 528-3441
www.ancorp.com



ISO-LF Flexible Nipple (Bellows)

Materials

- Flanges
- 304 stainless steel
- Flexible hose
- 321 stainless steel

Product Notes

- Corrects misaligned connections

Options: Call for price and delivery

- Larger sizes
- Custom lengths
- Custom flange combination
- ISO-QF large size flanges see pg. 5.3

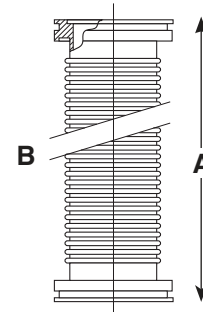

PART NUMBER	REFERENCE NUMBER	HOSE I.D.	WALL THICKNESS	A	B
0800069	LF63-250-F	2.5	0.008	6.00	4.50
0800070	LF80-300-F	3.0	0.008	6.00	4.50
0800071	LF100-400-F	4.0	0.010	6.00	4.50
0800072	LF160-600-F	6.0	0.012	8.00	5.70

*ORDERING NOTE

Rotatable style available. See pg. 6.33 ANSI/ASA Section



ASA/ANSI Flexible Nipple (Bellows)

Materials

- Flanges - 304 stainless steel
- Flexible hose
- 321 stainless steel formed bellows

Product Notes

- Corrects misaligned connections
- Both flanges have a fixed bolt hole orientation
- O-ring groove available (see chart pg. 6.32)

Options: Call for price and delivery

- Larger sizes
- Custom lengths
- Custom flange combination
- Alternative materials (i.e. 316 stainless steel)

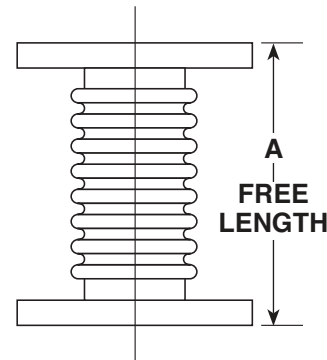

PART NUMBER	REFERENCE NUMBER	FLANGE TYPE	HOSE I.D.	WALL THICKNESS	A
0800182	100ASA-100-F	100ASA	1.00	0.006	4.00
0800183	100ASA-150-F	100ASA	1.50	0.006	4.00
0800184	150ASA-200-F	150ASA	2.00	0.006	4.00
0800186	150ASA-250-F	150ASA	2.50	0.008	6.00
0800187	200ASA-300-F	200ASA	3.00	0.008	6.00
0800188	300ASA-400-F	300ASA	4.00	0.010	6.00
0800189	400ASA-400-F	400ASA	4.00	0.010	6.00
0800190	400ASA-600-F	400ASA	6.00	0.012	8.00
0800191	600ASA-600-F	600ASA	6.00	0.012	8.00



ISO-QF/LF Flexible Metal Hose

Materials

- Flanges
- 304 stainless steel
- Formed flexible hose - 321 stainless steel

Product Notes

- Thin wall design provides maximum flexibility
- Medium wall design for price economy
- Corrects misaligned connections
- Provides vibration isolation

Options: Call for price and delivery

- Custom lengths
- Custom flange combination
- Braided metal hose

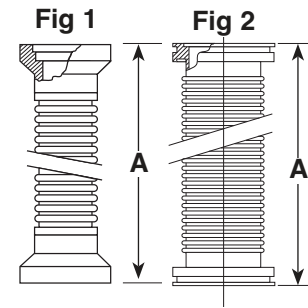

ISO-QF/LF Flexible Metal Hose - Thin Wall

REFERENCE NUMBER	FLANGES	DRAWING FIGURE	NOMINAL TUBE I. D.	WALL THICKNESS	OAL A
QF16-075-MH10	QF16	1	0.75	0.006	10
QF16-075-MH12	QF16	1	0.75	0.006	12
QF16-075-MH18	QF16	1	0.75	0.006	18
QF16-075-MH20	QF16	1	0.75	0.006	20
QF16-075-MH24	QF16	1	0.75	0.006	24
QF16-075-MH36	QF16	1	0.75	0.006	36
QF16-075-MH40	QF16	1	0.75	0.006	40
QF16-075-MH48	QF16	1	0.75	0.006	48
QF25-100-MH10	QF25	1	1.00	0.006	10
QF25-100-MH12	QF25	1	1.00	0.006	12
QF25-100-MH18	QF25	1	1.00	0.006	18
QF25-100-MH20	QF25	1	1.00	0.006	20
QF25-100-MH24	QF25	1	1.00	0.006	24
QF25-100-MH36	QF25	1	1.00	0.006	36
QF25-100-MH40	QF25	1	1.00	0.006	40
QF25-100-MH48	QF25	1	1.00	0.006	48
QF40-150-MH10	QF40	1	1.50	0.006	10
QF40-150-MH12	QF40	1	1.50	0.006	12
QF40-150-MH18	QF40	1	1.50	0.006	18
QF40-150-MH20	QF40	1	1.50	0.006	20
QF40-150-MH24	QF40	1	1.50	0.006	24
QF40-150-MH36	QF40	1	1.50	0.006	36
QF40-150-MH40	QF40	1	1.50	0.006	40
QF40-150-MH48	QF40	1	1.50	0.006	48
QF50-200-MH10	QF50	1	2.00	0.006	10
QF50-200-MH12	QF50	1	2.00	0.006	12
QF50-200-MH18	QF50	1	2.00	0.006	18
QF50-200-MH20	QF50	1	2.00	0.006	20
QF50-200-MH24	QF50	1	2.00	0.006	24
QF50-200-MH36	QF50	1	2.00	0.006	36
QF50-200-MH40	QF50	1	2.00	0.006	40
QF50-200-MH48	QF50	1	2.00	0.006	48

A&N Corporation

707 SW 19th Ave.
Williston, FL 32696
1(800) FLANGE1
FAX (352) 528-3441
www.ancorp.com



ISO-QF/LF Flexible Metal Hose - Medium Wall

REFERENCE NUMBER	FLANGES	DRAWING FIGURE	NOMINAL TUBE I.D.	WALL THICKNESS	OAL A
QF16-075-MH10-T	QF16	1	0.75	0.008	10
QF16-075-MH12-T	QF16	1	0.75	0.008	12
QF16-075-MH18-T	QF16	1	0.75	0.008	18
QF16-075-MH20-T	QF16	1	0.75	0.008	20
QF16-075-MH24-T	QF16	1	0.75	0.008	24
QF16-075-MH36-T	QF16	1	0.75	0.008	36
QF16-075-MH40-T	QF16	1	0.75	0.008	40
QF16-075-MH48-T	QF16	1	0.75	0.008	48
QF25-100-MH10-T	QF25	1	1.00	0.008	10
QF25-100-MH12-T	QF25	1	1.00	0.008	12
QF25-100-MH18-T	QF25	1	1.00	0.008	18
QF25-100-MH20-T	QF25	1	1.00	0.008	20
QF25-100-MH24-T	QF25	1	1.00	0.008	24
QF25-100-MH36-T	QF25	1	1.00	0.008	36
QF25-100-MH40-T	QF25	1	1.00	0.008	40
QF25-100-MH48-T	QF25	1	1.00	0.008	48
QF40-150-MH10-T	QF40	1	1.50	0.010	10
QF40-150-MH12-T	QF40	1	1.50	0.010	12
QF40-150-MH18-T	QF40	1	1.50	0.010	18
QF40-150-MH20-T	QF40	1	1.50	0.010	20
QF40-150-MH24-T	QF40	1	1.50	0.010	24
QF40-150-MH36-T	QF40	1	1.50	0.010	36
QF40-150-MH40-T	QF40	1	1.50	0.010	40
QF40-150-MH48-T	QF40	1	1.50	0.010	48
QF50-200-MH10-T	QF50	1	2.00	0.012	10
QF50-200-MH12-T	QF50	1	2.00	0.012	12
QF50-200-MH18-T	QF50	1	2.00	0.012	18
QF50-200-MH20-T	QF50	1	2.00	0.012	20
QF50-200-MH24-T	QF50	1	2.00	0.012	24
QF50-200-MH36-T	QF50	1	2.00	0.012	36
QF50-200-MH40-T	QF50	1	2.00	0.012	40
QF50-200-MH48-T	QF50	1	2.00	0.012	48
LF63-250-MH12-T	LF63	2	2.50	0.012	12
LF63-250-MH18-T	LF63	2	2.50	0.012	18
LF63-250-MH24-T	LF63	2	2.50	0.012	24
LF63-250-MH36-T	LF63	2	2.50	0.012	36
LF63-250-MH48-T	LF63	2	2.50	0.012	48
LF80-300-MH12-T	LF80	2	3.00	0.016	12
LF80-300-MH18-T	LF80	2	3.00	0.016	18
LF80-300-MH24-T	LF80	2	3.00	0.016	24
LF80-300-MH36-T	LF80	2	3.00	0.016	36
LF80-300-MH48-T	LF80	2	3.00	0.016	48
LF100-400-MH12-T	LF100	2	4.00	0.016	12
LF100-400-MH18-T	LF100	2	4.00	0.016	18
LF100-400-MH24-T	LF100	2	4.00	0.016	24
LF100-400-MH36-T	LF100	2	4.00	0.016	36
LF100-400-MH48-T	LF100	2	4.00	0.016	48



CF Flexible Metal Hose - Thin Wall

Materials

- Flanges
- 304 stainless steel
- Formed flexible hose
- 321 stainless steel

Product Notes

- Thin wall design provides maximum flexibility
- Corrects misaligned connections
- Provides vibration isolation

Options: Call for price and delivery

- Custom lengths
- Custom flange combination

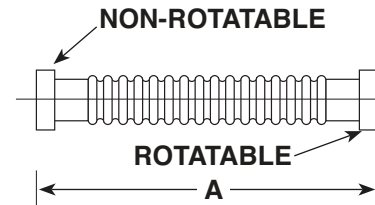

REFERENCE NUMBER	FLANGES	NOMINAL TUBE I. D.	WALL THICKNESS	OAL A
133X133-R-MH12	CF133	0.75	0.006	12
133X133-R-MH18	CF133	0.75	0.006	18
133X133-R-MH24	CF133	0.75	0.006	24
133X133-R-MH36	CF133	0.75	0.006	36
133X133-R-MH48	CF133	0.75	0.006	48
212X212-R-MH12	CF212	1.00	0.006	12
212X212-R-MH18	CF212	1.00	0.006	18
212X212-R-MH24	CF212	1.00	0.006	24
212X212-R-MH36	CF212	1.00	0.006	36
212X212-R-MH48	CF212	1.00	0.006	48
275X275-R-MH12	CF275	1.50	0.006	12
275X275-R-MH18	CF275	1.50	0.006	18
275X275-R-MH24	CF275	1.50	0.006	24
275X275-R-MH36	CF275	1.50	0.006	36
275X275-R-MH48	CF275	1.50	0.006	48
338X338-R-MH12	CF338	2.00	0.006	12
338X338-R-MH18	CF338	2.00	0.006	18
338X338-R-MH24	CF338	2.00	0.006	24
338X338-R-MH36	CF338	2.00	0.006	36
338X338-R-MH48	CF338	2.00	0.006	48

A&N Corporation

707 SW 19th Ave.
Williston, FL 32696
1(800) FLANGE1
FAX (352) 528-3441
www.ancorp.com



CF Flexible Metal Hose - Medium

Materials

- Flanges
- 304 stainless steel
- Formed Flexible Hose
- 321 stainless steel

Product Notes

- Medium wall design for price economy
- Corrects misaligned connections
- Provides vibration isolation

Options: Call for price and delivery

- Custom lengths
- Custom flange combination
- Braided metal hose

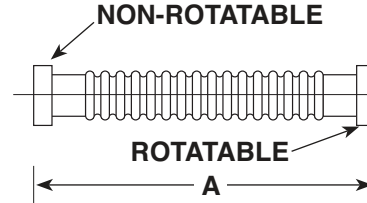

REFERENCE NUMBER	FLANGES	NOMINAL TUBE I.D.	WALL THICKNESS	OAL A
133X133-R-MH12-T	CF133	0.75	0.008	12
133X133-R-MH18-T	CF133	0.75	0.008	18
133X133-R-MH24-T	CF133	0.75	0.008	24
133X133-R-MH36-T	CF133	0.75	0.008	36
133X133-R-MH48-T	CF133	0.75	0.008	48
212X212-R-MH12-T	CF212	1.00	0.008	12
212X212-R-MH18-T	CF212	1.00	0.008	18
212X212-R-MH24-T	CF212	1.00	0.008	24
212X212-R-MH36-T	CF212	1.00	0.008	36
212X212-R-MH48-T	CF212	1.00	0.008	48
275X275-R-MH12-T	CF275	1.50	0.010	12
275X275-R-MH18-T	CF275	1.50	0.010	18
275X275-R-MH24-T	CF275	1.50	0.010	24
275X275-R-MH36-T	CF275	1.50	0.010	36
275X275-R-MH48-T	CF275	1.50	0.010	48
338X338-R-MH12-T	CF338	2.00	0.012	12
338X338-R-MH18-T	CF338	2.00	0.012	18
338X338-R-MH24-T	CF338	2.00	0.012	24
338X338-R-MH36-T	CF338	2.00	0.012	36
338X338-R-MH48-T	CF338	2.00	0.012	48
450X450-R-MH12-T	CF450	2.50	0.012	12
450X450-R-MH18-T	CF450	2.50	0.012	18
450X450-R-MH24-T	CF450	2.50	0.012	24
450X450-R-MH36-T	CF450	2.50	0.012	36
450X450-R-MH48-T	CF450	2.50	0.012	48
462X462-R-MH12-T	CF462	3.00	0.016	12
462X462-R-MH18-T	CF462	3.00	0.016	18
462X462-R-MH24-T	CF462	3.00	0.016	24
462X462-R-MH36-T	CF462	3.00	0.016	36
462X462-R-MH48-T	CF462	3.00	0.016	48
600X600-R-MH12-T	CF600	4.00	0.016	12
600X600-R-MH18-T	CF600	4.00	0.016	18
600X600-R-MH24-T	CF600	4.00	0.016	24
600X600-R-MH36-T	CF600	4.00	0.016	36
600X600-R-MH48-T	CF600	4.00	0.016	48

TECH TIP

Braided metal hose option provides protection for the thin wall metal hose from abrasion, impact and over-bending



Weldable End Flexible Metal Hose - Thin Wall

Materials

- Weldable tube ends
- 304 stainless steel
- Formed flexible hose
- 321 stainless steel

Options: Call for price and delivery

- Custom lengths
- Custom flange combination

Product Notes

- Thin wall design provides maximum flexibility
- Corrects misaligned connections
- Provides vibration isolation

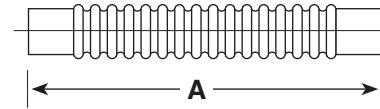

REFERENCE NUMBER	NOMINAL TUBE I.D.	WALL THICKNESS	OAL A
MH075-CE-12	0.75	0.006	12
MH075-CE-18	0.75	0.006	18
MH075-CE-24	0.75	0.006	24
MH075-CE-36	0.75	0.006	36
MH075-CE-48	0.75	0.006	48
MH100-CE-12	1.00	0.006	12
MH100-CE-18	1.00	0.006	18
MH100-CE-24	1.00	0.006	24
MH100-CE-36	1.00	0.006	36
MH100-CE-48	1.00	0.006	48
MH150-CE-12	1.50	0.006	12
MH150-CE-18	1.50	0.006	18
MH150-CE-24	1.50	0.006	24
MH150-CE-36	1.50	0.006	36
MH150-CE-48	1.50	0.006	48
MH200-CE-12	2.00	0.006	12
MH200-CE-18	2.00	0.006	18
MH200-CE-24	2.00	0.006	24
MH200-CE-36	2.00	0.006	36
MH200-CE-48	2.00	0.006	48

A&N Corporation

707 SW 19th Ave.
Williston, FL 32696
1(800) FLANGE1
FAX (352) 528-3441
www.ancorp.com



Weldable End Flexible Metal Hose - Medium Wall

Materials

- Weldable Tube Ends
- 304 stainless steel
- Formed Flexible Hose
- 321 stainless steel

Options: Call for price and delivery

- Custom Lengths
- Custom Flange Combination
- Braided Metal Hose

Product Notes

- Medium wall design for price economy
- Corrects misaligned connections
- Provides vibration isolation

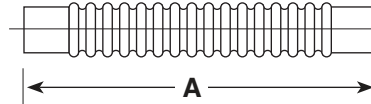

REFERENCE NUMBER	NOMINAL TUBE I.D.	WALL THICKNESS	OAL A
MH075-CE-12-T	0.75	0.008	12
MH075-CE-18-T	0.75	0.008	18
MH075-CE-24-T	0.75	0.008	24
MH075-CE-36-T	0.75	0.008	36
MH075-CE-48-T	0.75	0.008	48
MH100-CE-12-T	1.00	0.008	12
MH100-CE-18-T	1.00	0.008	18
MH100-CE-24-T	1.00	0.008	24
MH100-CE-36-T	1.00	0.008	36
MH100-CE-48-T	1.00	0.008	48
MH150-CE-12-T	1.50	0.010	12
MH150-CE-18-T	1.50	0.010	18
MH150-CE-24-T	1.50	0.010	24
MH150-CE-36-T	1.50	0.010	36
MH150-CE-48-T	1.50	0.010	48
MH200-CE-12-T	2.00	0.012	12
MH200-CE-18-T	2.00	0.012	18
MH200-CE-24-T	2.00	0.012	24
MH200-CE-36-T	2.00	0.012	36
MH200-CE-48-T	2.00	0.012	48
MH250-CE-12-T	2.50	0.012	12
MH250-CE-18-T	2.50	0.012	18
MH250-CE-24-T	2.50	0.012	24
MH250-CE-36-T	2.50	0.012	36
MH250-CE-48-T	2.50	0.012	48
MH300-CE-12-T	3.00	0.016	12
MH300-CE-18-T	3.00	0.016	18
MH300-CE-24-T	3.00	0.016	24
MH300-CE-36-T	3.00	0.016	36
MH300-CE-48-T	3.00	0.016	48
MH400-CE-12-T	4.00	0.016	12
MH400-CE-18-T	4.00	0.016	18
MH400-CE-24-T	4.00	0.016	24
MH400-CE-36-T	4.00	0.016	36
MH400-CE-48-T	4.00	0.016	48

TECH TIP

Braided metal hose option provides protection for the thin wall metal hose from abrasion, impact and over-bending



QF Flexible PVC Hose

Materials

- PVC hose - clear, wire reinforced
- Flanges - 304 stainless steel
- Temperature range: min. 20° F, max. 150° F

Options: Call for price and delivery

- Custom lengths

Product Notes

- Hose clamp fastens flange to PVC hose
- Ready to use – helium leak checked
- Good for exhaust lines

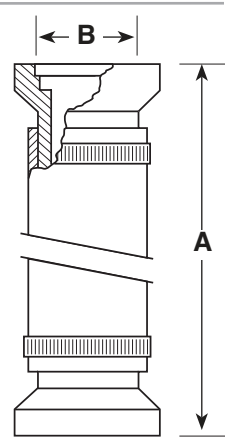

REFERENCE NUMBER	A	B	MAX. PSI
QF10-PVC20	20	0.50	130
QF10-PVC40	40	0.50	130
QF16-050-PVC20	20	0.50	130
QF16-050-PVC40	40	0.50	130
QF16-PVC20	20	0.75	100
QF16-PVC40	40	0.75	100
QF25-PVC20	20	1.00	70
QF25-PVC40	40	1.00	70
QF40-PVC20	20	1.50	50
QF40-PVC40	40	1.50	50
QF50-PVC20	20	2.00	50
QF50-PVC40	40	2.00	50

Flexible PVC Hose

Materials

- PVC hose - clear, wire reinforced
- Temperature range: min. 20° F, max. 150° F

Product Notes

- Hose clamp fastens flange to PVC hose
- Good for exhaust lines
- Length is cut to order

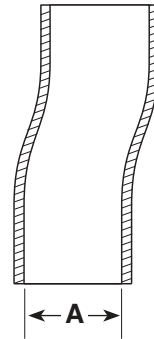

REFERENCE NUMBER	HOSE CLAMP PART NUMBER	A	MAX. PSI
050-PVC-R	050-HC	0.50	130
075-PVC-R	075-HC	0.75	100
100-PVC-R	100-HC	1.00	70
150-PVC-R	150-HC	1.50	50
200-PVC-R	200-HC	2.00	50

A&N Corporation

707 SW 19th Ave.
 Williston, FL 32696
 1(800) FLANGE1
 FAX (352) 528-3441
 www.ancorp.com



Hose Adapter to QF - Aluminum

Materials

- 2011 aluminum

Product Notes

- Adapts from rubber or PVC vacuum hose to ISO-QF flanges

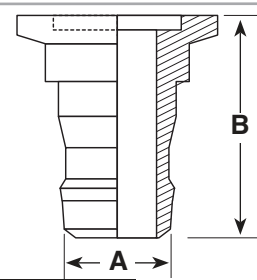

PART NUMBER	REFERENCE NUMBER	HOSE SIZE (I.D.)	A	B
4000256	QF10-50/63-H	0.50 or 0.63	0.63	1.63
4000257	QF16-50/63-H	0.50 or 0.63	0.63	1.63
4000258	QF16-63/75-H	0.63 or 0.75	0.75	1.63
4000259	QF25-50/63-H	0.50 or 0.63	0.63	1.63
4000261	QF25-75/88-H	0.75 or 0.88	0.88	1.73
4000262	QF40-150/163-H	1.50 or 1.63	1.63	2.17
4000263	QF50-150/163-H	1.50 or 1.63	1.63	2.17



Hose Adapter to QF - Stainless Steel

Materials

- 304 stainless steel

Product Notes

- Adapts from rubber or PVC vacuum hose to ISO-QF flanges

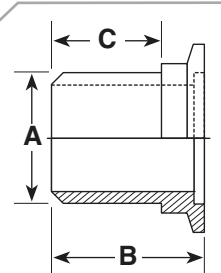

PART NUMBER	REFERENCE NUMBER	HOSE SIZE (I.D.)	A	B	C
4000264	QF10-050-SH	0.50	0.50	1.26	0.79
4000265	QF16-050-SH	0.50	0.50	1.26	0.79
4000266	QF16-075-SH	0.75	0.75	1.26	0.79
4000267	QF25-100-SH	1.00	1.00	1.50	1.02
4000268	QF40-150-SH	1.50	1.50	1.97	1.50
4000269	QF50-200-SH	2.00	2.00	2.17	1.61



Hose Clamps

REFERENCE NUMBER	DESCRIPTION
050-HC	PVC Hose Clamp for 1/2 in. tubing
075-HC	PVC Hose Clamp for 3/4 in. tubing
100-HC	PVC Hose Clamp for 1 in. tubing
150-HC	PVC Hose Clamp for 1 1/2 in. tubing
200-HC	PVC Hose Clamp for 2 in. tubing



PVC Vacuum Fittings

Specifications

- Materials: Schedule 80 Polyvinyl Chloride (PVC)
- Vacuum rating: low vacuum 5×10^{-3} Torr
- Temperature rating: 60°C max.

Features

- Corrosion resistant
- ISO-QF compatible adapters
- Easily customizable on site
- Economical solution for rough vacuum and vacuum exhaust lines

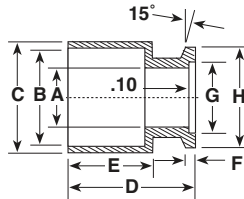

PVC Weld Flange

- PVC
- Adapts to all nom. 1 inch PVC-K100 Series fittings and PVCT-100 tubing

REFERENCE NUMBER	REF ISO	A	B	C	D	E	F	G	H
PVC16-SF	NW16	0.62	1.06	1.31	1.75	1.18	0.12	0.67	1.16

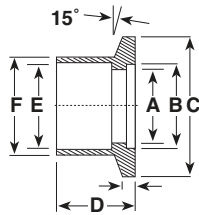

PVC Weld Flange

- PVC

REFERENCE NUMBER	REF ISO	PVC NOM SIZE	A	B	C	D	E	F
PVC25-SF	NW25	1	0.80	1.03	1.57	1.17	1.06	1.20
PVC40-SF	NW40	1 1/2	1.09	1.62	2.16	1.21	1.32	1.70
PVC50-SF	NW50	2	1.62	2.06	2.95	1.23	1.91	2.20

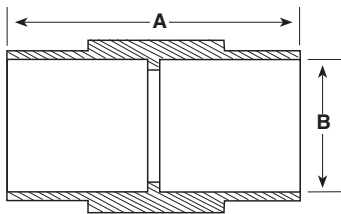

PVC Couplings

- PVC

REFERENCE NUMBER	REF ISO	PVC NOM SIZE	A	B	WT LBS
PVC100-CPL	NW25	1	2.18	1.06	1/2
PVC150-CPL	NW40	1 1/2	2.44	1.32	1/2
PVC200-CPL	NW50	2	2.98	1.91	1/2

PVC Sealer

Primer

- Fast acting clear primer
- Softens and prepares PVC Tube and Flange
- To be used with cement

Cement

- For all sizes and types of PVC
- Sets up rapidly and provides strong leak-tight weld
- Hundreds of PVC welds in each can

REFERENCE NUMBER	WT LBS
------------------	--------

PVC-PRMR	3
PVC-CMT	3

A&N Corporation

707 SW 19th Ave.
Williston, FL 32696
1(800) FLANGE1
FAX (352) 528-3441
www.ancorp.com



PVC 45° Elbow

- PVC

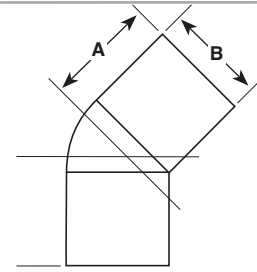

REFERENCE NUMBER	REF ISO	PVC NOM SIZE	A	ID B	WT LBS
PVC100-E45	NW25	1	1.50	1.06	1/2
PVC150-E45	NW40	1 1/2	1.75	1.32	3/4
PVC200-E45	NW50	2	2.15	1.91	3/4

PVC 90° Elbow

- PVC

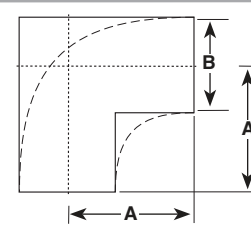

REFERENCE NUMBER	REF ISO	PVC NOM SIZE	A	ID B	WT LBS
PVC100-E90	NW25	1	1.60	1.06	1/2
PVC150-E90	NW40	1 1/2	1.85	1.32	3/4
PVC200-E90	NW50	2	2.35	1.91	3/4

PVC Tees

- PVC

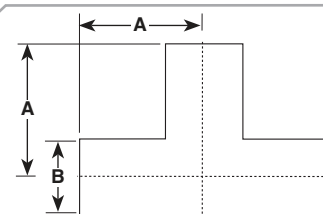

REFERENCE NUMBER	REF ISO	PVC NOM SIZE	A	ID B	WT LBS
PVC100-T	NW25	1	1.60	1.06	3/4
PVC150-T	NW40	1 1/2	2.10	1.32	1 1/2
PVC200-T	NW50	2	2.40	1.91	1 1/2

PVC Tube

- PVC

REFERENCE NUMBER	PVC NOM SIZE	TUBE O.D.	MIN THICK WALL
100-PVC	1	1.06	0.179
150-PVC	1 1/2	1.32	0.200
200-PVC	2	1.91	0.218

